



Morgan County COURTHOUSE RENOVATION

April 2025

New Judicial Campus – Opening This Summer

The grand opening for the new Judicial Campus is tentatively scheduled for July 2, 2025. This new, \$46 million building features:

- Courtrooms for one Circuit Court, three Superior Courts and two Hearing Courts
- 71,800 square feet over three floors
- 21 restrooms
- New 202-space parking lot

All employees and offices in the current Courthouse will be moved in by end of July.



Existing Courthouse Renovations

After the judicial building opens, the next phase for the County will be to remodel the existing Courthouse from summer 2025 to early 2027. The exterior renovation includes reconfigured parking, new sidewalks, and ADA-compliant ramps and curbs.

Once complete, the existing courthouse will provide office space for professionals who currently work in the Administration Building and several other buildings throughout downtown Martinsville.

Careful consideration about the exterior Courthouse renovations have been given to minimize impacts on the City of Martinsville and the downtown businesses on or adjacent to the Courthouse Square.

Morgan County hosted two informational meetings with those businesses to discuss street and parking impacts of the preferred phasing, as well as other phasing options that were considered.

Preferred Exterior Phasing Plan

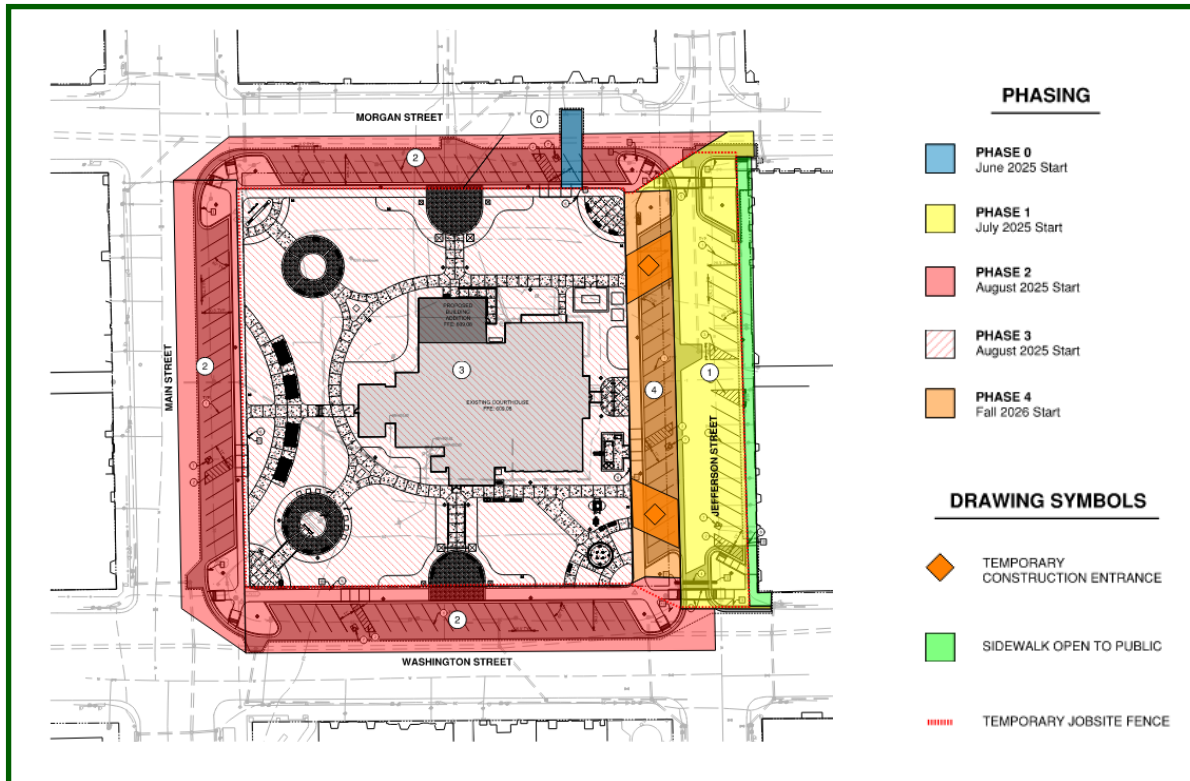

Jefferson Street

The preferred phasing plan will close Jefferson Street for approximately four weeks beginning in mid-July. Jefferson Street and diagonal parking on the east side of the Courthouse will open in August and new parking on the west side will open in Fall 2026. The south sidewalk will close for two days to pour new curbs and a sidewalk extension.

Morgan, Main and Washington

Work on Morgan, Main and Washington streets will not begin until Jefferson reopens. Work on these streets will last about 16 weeks, with one lane closed, allowing one-way traffic.

Under the preferred phasing, all streets adjacent to the Courthouse will be open by Thanksgiving 2025. Also opening are:

- Parking spaces
- Sidewalks
- Signage
- ADA ramps
- 67 parking spaces (2 new)

Alternate Phasing Plan 1

Morgan, Main and Washington Streets

Under alternative phasing plan 1, work will begin on Morgan, Main and Washington streets first, in August 2025. These 16 weeks of work, expected to last until Thanksgiving 2025, will include:

- Parking spaces
- Sidewalks
- Signage
- ADA ramps
- 67 parking spaces (2 new)

Jefferson Street

In this alternative phase, Jefferson Street would not close until Fall 2026, well after Morgan, Main and Washington streets are open. Parking will be open on half of Jefferson Street and in 10 existing, east parking spaces. The sidewalk will remain open with the exception of a two-day closure on the south end while new curbs and a portion of the sidewalk are poured.

Altogether, alternative phasing plan 1 would last more than six months. Work on Morgan, Main and Washington streets would occur in 2025, then there would be a nine-month break before work on Jefferson Street would begin in Fall 2026.

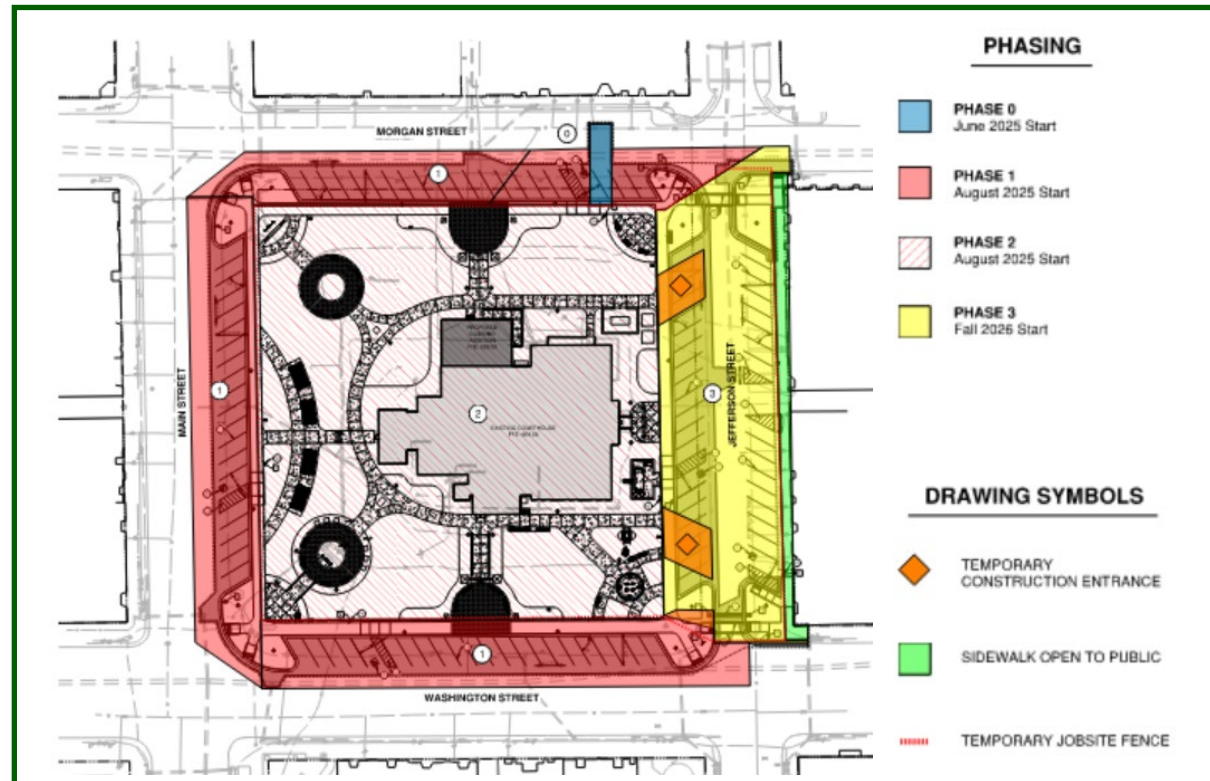

Alternate Phasing Plan 2

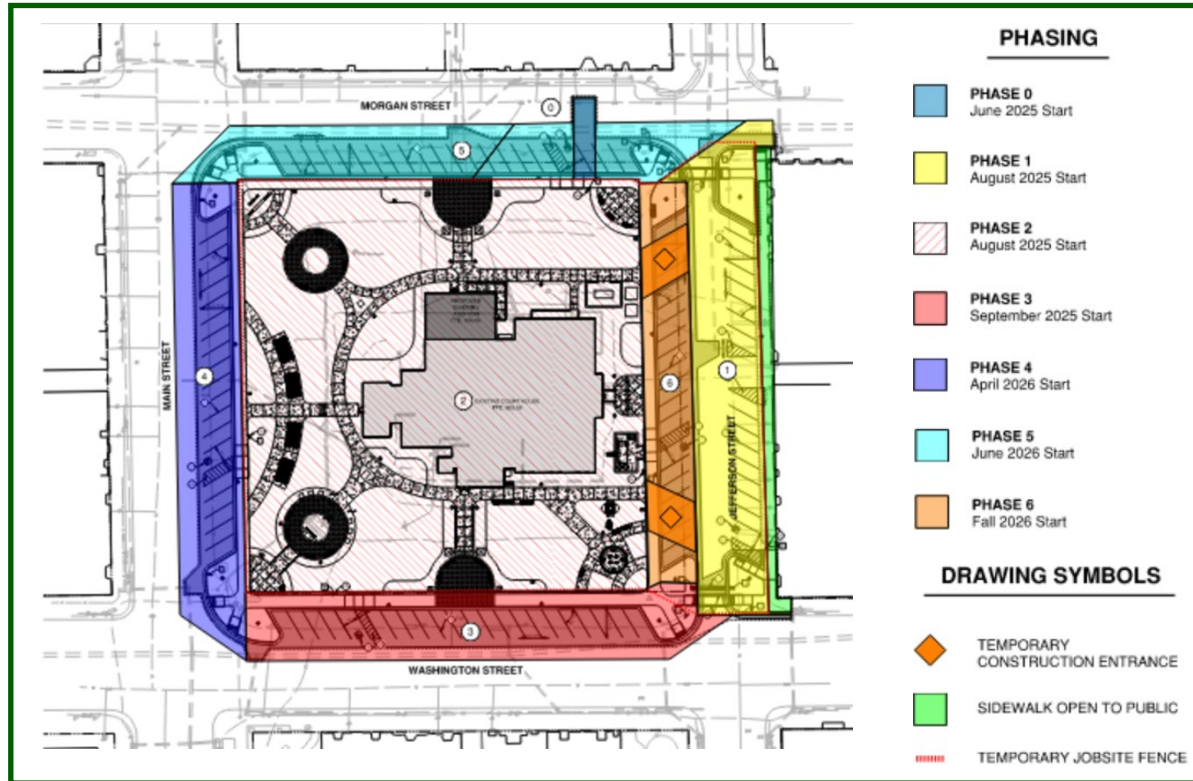

Jefferson Street - East

Under alternative phasing plan 2, only the east side of Jefferson Street will close in August 2025 for approximately four weeks.

Washington Street

Once the east side of Jefferson Street reopens, one-half of Washington Street will close for six weeks, from about early October until Thanksgiving 2025.

Main Street

Main Street would close in April 2026 for approximately six weeks. Only one lane would be closed.

Morgan Street

Once Main Street fully reopens, one lane of Morgan Street would close from about late May until mid or late July 2026.

Jefferson Street – West

The west side of Jefferson Street would close after Morgan Street reopens, likely in late July 2026.

Alternative phasing plan 2 would last more than 15 months, with a five-month gap between work on Washington and Main streets.

Impact Schedule Comparison

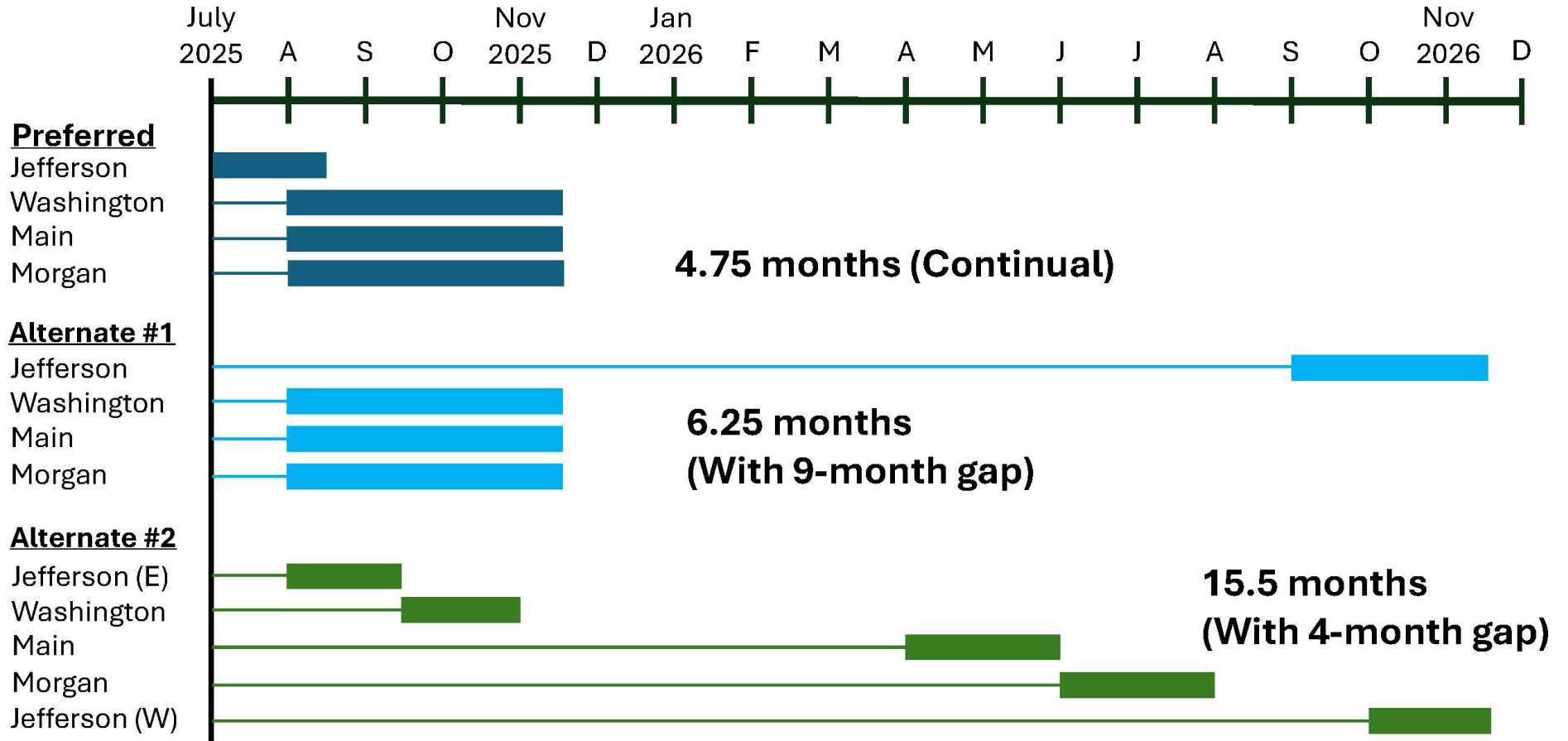

Parking Impacts

Preferred Phasing Plan



During the preferred phasing plan, 42 spaces on Main, Morgan and Washington streets (marked in blue) would remain open at all times. In August 2025, 23 spaces would open on Jefferson (peach), and by Thanksgiving 2025, 63 more spaces would open.

Alternative Phase Plan 1



During alternative phase plan 1, 42 spaces on Main, Morgan and Washington Streets (marked in blue) would remain open at all times, with an additional 10 spaces along Jefferson Street. Sixty-three (63) more spaces (peach) would open by Thanksgiving 2025 and 23 more spaces would open on Jefferson Street in late 2026.

Alternative Phasing Plan 2

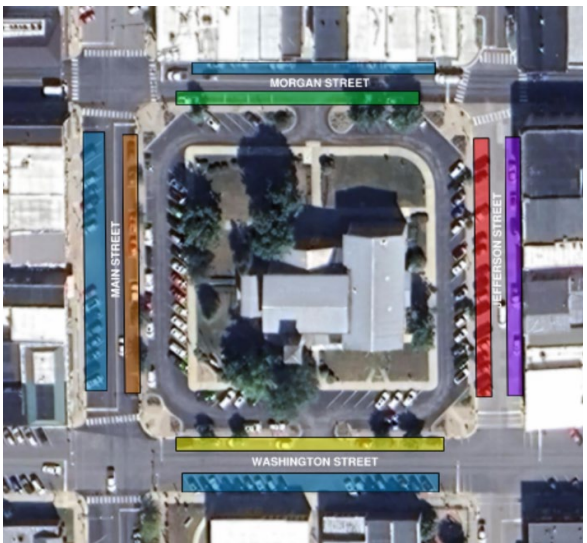

During alternative phase 2, 42 spaces on Main, Morgan and Washington Streets (blue) would remain open at all times. Parking spaces would be closed during each street closure, with overall parking availability varying throughout the 15+-month period.

During the Courthouse renovation, contractors MAY NOT park in public parking. Contractors MAY park at:

- 214 N. Main Street, designated by the City
- New lot at 69 W Columbus Street, south of the new Judicial Campus
- Inside site limits and only using designated construction entrances shown on the phasing plan

Overall Parking Improvements

Once the entire \$72 million judicial campus construction and Courthouse renovations are complete, parking in downtown Martinsville will include 515 total parking spaces, distributed at:

- Pike/Mulberry (pink, 20)
- Pike/Main (red, 24)
- Morgan/Sycamore (yellow, 16)
- Jefferson/Jackson (green, 26)
- Courthouse Square (gold, 146)
- Morgan/Wayne (52, purple)
- Mulberry/Marion/Jackson/Columbus (turquoise, 202)
- Mulberry/Columbus (dark blue, 29)

